

Floating joint FJ10 series



3
Execute
equipment

How to order

FJ10 - **08**

Series code

Port size

Specification

Model	FJ1008	FJ1010	FJ1012	FJ1016	FJ1020	FJ1027	FJ1036
Port size	M8x1.25	M10x1.25	M12x1.25	M16x1.5	M20x1.5	M27x2.0	M36x2.0

Dimension

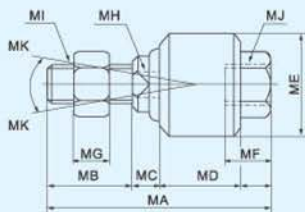

Bore size (mm)	MA	MB	MC	MD	ME	MF	MG	MH	M1	MJ	MK
20	51	20	6	17	24	11.5	6	8	M8x1.25	M8x1.25	13°
25	58	22	7	21	26	11.5	7	10	M10x1.25	M10x1.25	12°
32	58	22	7	21	26	11.5	7	10	M10x1.25	M10x1.25	12°
40	58	22	8	21	28	11.5	8	12	M12x1.25	M12x1.25	12°
50	90	27	10	41	44.5	20	10	17	M16x1.5	M16x1.5	7°
63	90	27	10	41	44.5	20	10	17	M16x1.5	M16x1.5	7°
80	102	29	13	46	53	24	13	22	M20x1.5	M20x1.5	10°
100	102	29	13	46	53	24	13	22	M20x1.5	M20x1.5	10°
125	147	54	13	64	62	39	14	30	M27x2.0	M27x2.0	9°
160	251	72	22	115	80	80	18	36	M36x2.0	M36x2.0	4°
200	251	72	22	115	80	80	18	36	M36x2.0	M36x2.0	4°